

2.0MM MANDIBLE CORTEX SCREW (STANDARD PITCH 1.0MM) SELF TAPPING

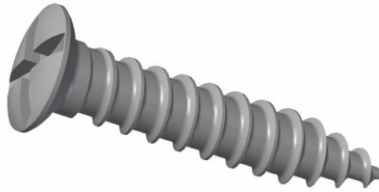

2.0MM MANDIBLE CORTEX SCREW (STANDARD PITCH 1.0MM) SELF TAPPING	
CAT. NO.	PRODUCT DESCRIPTION
706.315	2.0MM MANDIBLE CORTEX SCREW (STANDARD PITCH 1.0MM) SELF TAPPING 5.0MM
706.316	2.0MM MANDIBLE CORTEX SCREW (STANDARD PITCH 1.0MM) SELF TAPPING 6.0MM
706.318	2.0MM MANDIBLE CORTEX SCREW (STANDARD PITCH 1.0MM) SELF TAPPING 8.0MM
706.320	2.0MM MANDIBLE CORTEX SCREW (STANDARD PITCH 1.0MM) SELF TAPPING 10.0MM
706.322	2.0MM MANDIBLE CORTEX SCREW (STANDARD PITCH 1.0MM) SELF TAPPING 12.0MM
706.324	2.0MM MANDIBLE CORTEX SCREW (STANDARD PITCH 1.0MM) SELF TAPPING 14.0MM
706.326	2.0MM MANDIBLE CORTEX SCREW (STANDARD PITCH 1.0MM) SELF TAPPING 16.0MM
706.328	2.0MM MANDIBLE CORTEX SCREW (STANDARD PITCH 1.0MM) SELF TAPPING 18.0MM

Specification

- Screw is available in titanium.

Indication for use

- The 2.0mm Mandible Cortex Screw (Standard Pitch 1.0mm) Self Tapping is indicated for use in the fixation of mandibular fractures and osteotomies. It provides stable fixation of bone fragments in maxillofacial and craniofacial surgical procedures.