

LCP MANDIBLE LOCKING SCREWS SELF TAPPING Ø2.0 MM

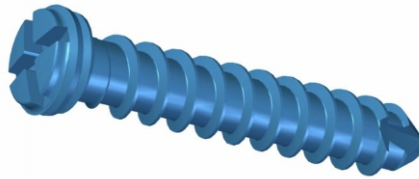

LCP MANDIBLE LOCKING SCREWS SELF TAPPING Ø2.0 MM

CAT. NO.	PRODUCT DESCRIPTION
706.105	LCP MANDIBLE LOCKING SCREWS SELF TAPPING Ø2.0 MM X 5 MM
706.106	LCP MANDIBLE LOCKING SCREWS SELF TAPPING Ø2.0 MM X 6 MM
706.108	LCP MANDIBLE LOCKING SCREWS SELF TAPPING Ø2.0 MM X 8 MM
706.110	LCP MANDIBLE LOCKING SCREWS SELF TAPPING Ø2.0 MM X 10 MM
706.112	LCP MANDIBLE LOCKING SCREWS SELF TAPPING Ø2.0 MM X 12 MM
706.114	LCP MANDIBLE LOCKING SCREWS SELF TAPPING Ø2.0 MM X 14 MM
706.116	LCP MANDIBLE LOCKING SCREWS SELF TAPPING Ø2.0 MM X 16 MM
706.118	LCP MANDIBLE LOCKING SCREWS SELF TAPPING Ø2.0 MM X 18 MM

Specification

- Screw is available in titanium.

Indication for use

- The Ø2.0 mm LCP Mandible Locking Self-Tapping Screws are used for the rigid internal fixation of mandibular fractures, osteotomies, and reconstructions. Designed for use with locking compression plates (LCP), these screws provide angular stability and enhanced fixation in cortical bone without the need for pre-tapping.