

# MAXILLOFACIAL EMERGENCY SCREW SELF DRILLING Ø1.8 MM

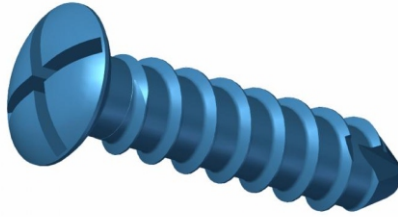

MAXILLOFACIAL EMERGENCY SCREW SELF DRILLING Ø1.8 MM	
CAT. NO.	PRODUCT DESCRIPTION
706.033	MAXILLOFACIAL EMERGENCY SCREW SELF DRILLING Ø1.8 MM X 3 MM
706.034	MAXILLOFACIAL EMERGENCY SCREW SELF DRILLING Ø1.8 MM X 4 MM
706.035	MAXILLOFACIAL EMERGENCY SCREW SELF DRILLING Ø1.8 MM X 5 MM
706.036	MAXILLOFACIAL EMERGENCY SCREW SELF DRILLING Ø1.8 MM X 6 MM
706.038	MAXILLOFACIAL EMERGENCY SCREW SELF DRILLING Ø1.8 MM X 8 MM
706.040	MAXILLOFACIAL EMERGENCY SCREW SELF DRILLING Ø1.8 MM X 10 MM
706.042	MAXILLOFACIAL EMERGENCY SCREW SELF DRILLING Ø1.8 MM X 12 MM
706.044	MAXILLOFACIAL EMERGENCY SCREW SELF DRILLING Ø1.8 MM X 14 MM
706.046	MAXILLOFACIAL EMERGENCY SCREW SELF DRILLING Ø1.8 MM X 16 MM
706.048	MAXILLOFACIAL EMERGENCY SCREW SELF DRILLING Ø1.8 MM X 18 MM

## Specification

- Screw is available in titanium.

## Indication for use

- The Ø1.8 mm Maxillofacial Emergency Self-Drilling Screw is intended for temporary stabilization of maxillofacial bone fragments in trauma cases. It is primarily used in emergency situations to provide rapid fixation without the need for pre-drilling, ensuring quick and effective bone stabilization during surgical intervention.

