

# MAXILLOFACIAL SCREWS (SELF - TAPPING) - HEAD CROSS SLOT Ø1.5 MM

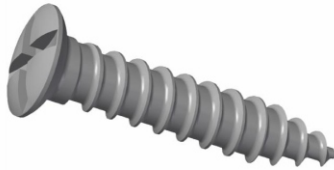

## MAXILLOFACIAL SCREWS (SELF - TAPPING) - HEAD CROSS SLOT Ø1.5 MM

CAT. NO.	PRODUCT DESCRIPTION
600.204	MAXILLOFACIAL SCREWS (SELF - TAPPING) - HEAD CROSS SLOT Ø1.5 MM X 4.0 MM
600.205	MAXILLOFACIAL SCREWS (SELF - TAPPING) - HEAD CROSS SLOT Ø1.5 MM X 5.0 MM
600.206	MAXILLOFACIAL SCREWS (SELF - TAPPING) - HEAD CROSS SLOT Ø1.5 MM X 6.0 MM
600.208	MAXILLOFACIAL SCREWS (SELF - TAPPING) - HEAD CROSS SLOT Ø1.5 MM X 8.0 MM
600.210	MAXILLOFACIAL SCREWS (SELF - TAPPING) - HEAD CROSS SLOT Ø1.5 MM X 10 MM
600.212	MAXILLOFACIAL SCREWS (SELF - TAPPING) - HEAD CROSS SLOT Ø1.5 MM X 12 MM
600.214	MAXILLOFACIAL SCREWS (SELF - TAPPING) - HEAD CROSS SLOT Ø1.5 MM X 14 MM
600.216	MAXILLOFACIAL SCREWS (SELF - TAPPING) - HEAD CROSS SLOT Ø1.5 MM X 16 MM

### Specification

- Screw is available in titanium.

### Indication for use

- Maxillofacial Self-Tapping Screws (Head Cross Slot Ø1.5 mm) are used for rigid fixation of small facial bones in trauma, reconstructive, and orthognathic surgeries. They provide stable fixation for mini-plates in delicate anatomical regions, enabling proper bone healing and alignment.